

Store at room temperature: 15-30 °C (59-86 °F)
Protect from sunlight
Keep away from children
Not suitable for use directly on the body.
Do not swallow



Batch Code and expiration date on the packaging and labeling

Diagnosis S.A.
ul. Gen. W. Andersa 38A
15-113 Białystok, Poland
www.diagnosis.pl

Rev. 2016.06.23
ANGIELSKA
- INSTRUKCJA na podstawie
polskiej wersji z dnia 2016.04.12

INTERPRETATION OF RESULTS

POSITIVE TEST RESULT - the trace of a blue-green color on the test area.
The blood was detected in the stool. A positive test result does not always mean that a problem exists, e.g. certain medicines can cause a false result as previously mentioned.

NEGATIVE TEST RESULT - no trace of a blue-green color on the test area indicates that at the time of your test there was no detectable blood in the stool. However, some conditions may not cause bleeding all the time. If you have a negative test, but have one or more of the following symptoms, consult your physician: 1. Diarrhea or constipation lasting longer than two weeks, 2. Unexplained weight loss, 3. Visible blood in the stool, 4. Dark black stool.

WARNING: This is a screening test and should not be used to confirm the existence or absence of any disease condition. It is not a replacement for colonoscopy or sigmoido-scopy. If you have any symptoms that concern you consult your physician - even if your test results are negative.

COMMON QUESTIONS

- Q. Why test for water quality?
- A. In some regions or on certain days the water may contain substances that interfere with this test and one could get false positive result.
- Q. What do I do when the Water Quality Check is positive (blue-green)?
- A. Wait 3 days, prepare the toilet as in Step #1, but skip Step #3 since you have one less test tissue. If the water check is again positive, the water in your toilet is unsuitable for this test.

- Q. What does it mean when the result of the Test Performance is orange instead of blue-green?
- A. The Positive Control powder on the surface of the water is not completely dissolved and causes an overreaction with the test tissue. The overreaction appears as an orange or rust color. In this case the test result is considered "positive".
- Q. Is the stool test "positive" when there is only a small speck of blue-green color on the test area?
- A. Yes. Any visible blue-green color in the test area is considered a "positive" result.

	Temperature limit		Consult instruction for use
	Batch Code		Do not re-use
	Use-by date		In vitro diagnostic medical device
	Manufacturer		Catalogue number
	Contains sufficient for <n> tests	Rev.	Last updated
	Do not use if package is damaged		Keep dry
	Keep away from sunlight		

FECAL OCCULT BLOOD TEST

HemoActive

INSTRUCTION FOR USE

READ THE INSTRUCTION FOR USE CAREFULLY AND
COMPLETELY BEFORE PERFORMING THIS TEST

Self-testing device
Not for internal use.
For in vitro diagnostic use.

WHY TEST YOURSELF FOR STOOL BLOOD?

In their early stages, colorectal diseases such as cancer, ulcers, hemorrhoids, polyps, colitis, diverticulitis, and fissures may not show any visible symptoms. HemoActive can detect this unseen blood and thereby serves as an early warning signal of bowel troubles that need medical attention. The test detects hemoglobin in a 2,0 mg % hemoglobin solution.

CONTENTS OF THE TEST KIT

The kit contains 5 Test Tissues inside large pouch, the Positive Control, the Test Result Card.

NOTE: Throw away the desiccant sachet when you open the sealed pouch.

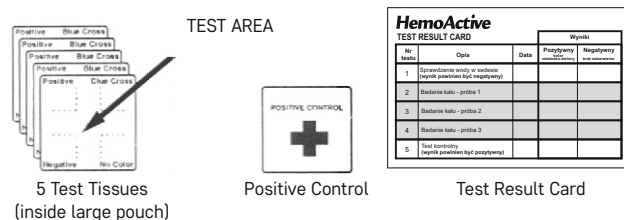

CAUTION: Do not get the chemicals in the Positive Control package in the eyes or on the skin. If the chemicals came into contact with eyes or skin flush with large amounts of water. Do not inhale the chemicals, they may cause irritation.

MEDICATION AND DIET

Two days prior to and during the testing period, avoid aspirin containing medicines, anti-inflammatory drugs, and rectal ointments. If you are taking medication, including prescribed doses of iron, consult with your physician before testing.

No diet restrictions are required (rare meat and Vitamin C are okay). However, for two days before and during testing, try to eat vegetables, fruits, and cereals.

PRECAUTIONS

- Do not perform the test during menstrual bleeding, bleeding hemorrhoids, or constipation.
- Store unused test tissues at room temperature and protect from sunlight and moisture.
- Do not ingest or inhale contents of Positive Control
- Keep out of reach of children.
- Do not take any decision of medical relevance without first consulting medical practitioner after performing the test.

TEST SUMMARY

There are three steps to the HemoActive procedure:

Step 1. Water quality check (before first stool test).

Step 2. Stool test (3 consecutive bowel movements).

Step 3. Test performance (one time only - Positive Control is used here).

TEST DIRECTIONS

Step 1. Water Quality Check

Remove all toilet cleaners, disinfectants or deodorizers from the toilet bowl and tank. Flush the toilet bowl several times before testing.

- Cut open the large pouch at the dotted line.
- Take one Test Tissue out of the pouch. Float the Test Tissue on top of the toilet water. Wait 2 minutes.
- If the toilet is clean, you should see no blue-green color on the Test Tissue.
- If there is a blue-green color on the Test Tissue, wait three (3) days and repeat Step #1 and skip Step #3.
- Flush the toilet bowl

NOTE: If you are color blind or visually impaired, have someone else read the results.

Step 2. Stool Test

- If necessary, urinate first, then flush toilet. The possibility of hematuria, bleeding hemorrhoids can affect the test results
- Have a bowel movement. Do not flush the toilet. Remove another Test Tissue from the pouch and float it onto the toilet water. The Test Tissue does not need to touch the stool.

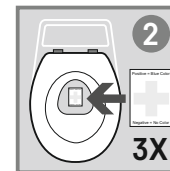
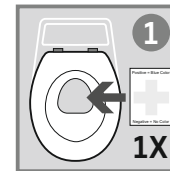

Fold & close the opened end of the pouch to protect the remaining tissues from moisture.

- Within 2 minutes, the trace of a blue-green color on the test area indicates the positive result (detectable blood in the stool). No trace of a blue-green color in the cross indicates negative result (no detectable blood in the stool)
- Flush the toilet.
- Record the result on the Test Result Card by marking an "X" for color or no color.
- Next days, for the second and third bowl movements repeat Step #2 "a" to "e". Record the result on the Test Result Card.

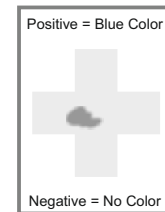

Step 3. Test Performance

NOTE:

This step must be completed in order for your test results to be valid.

After Step #2 Stool Tests you should complete Step #3 Test Performance.

- Flush the toilet.
- Carefully tear open the Positive Control Package (small foil pouch) and sprinkle its contents into the toilet.
- Wait one minute, drop the last Test Tissue into the toilet bowl. Within two minutes, a blue-green cross should appear on the tissue, meaning that your Test Tissue have worked properly.
- Wash your hands. Record the result on the Test Result Card.