

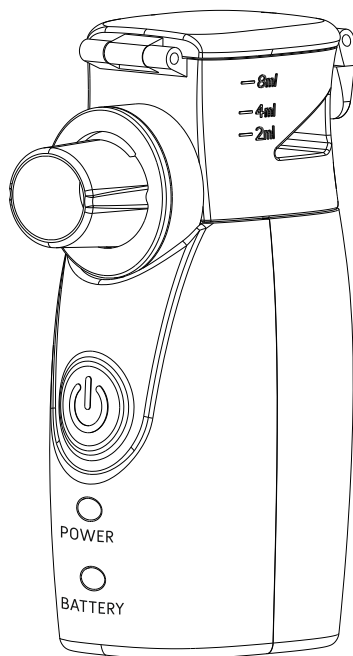

# DIAGNOSTIC **PRO MESH** MESH NEBULIZER

## INSTRUCTION FOR USE

---



 **DIAGNOSIS S.A.**  
ul. Gen. W. Andersa 38A  
15-113 Białystok, Poland  
[www.diagnosis.pl](http://www.diagnosis.pl)

 0197

**REF** 7020

Rev. 2020.12.18 v.6

# CONTENTS

Safety precautions .....	2
Product characteristics .....	3
Product features .....	4
How to assemble the nebulizer .....	4
How to connect to the power supply .....	5
How to fill the device with medication.....	6
How to operate the nebulizer .....	7
Cleaning and disinfection .....	8
How to replace the medication chamber .....	10
How to store the nebulizer and accessories.....	11
Troubleshooting .....	12
Technical specification .....	15
Sprayed Particles Magnitude.....	16
Accessories / replacement parts .....	16
Symbols description.....	17
Electromagnetic compatibility .....	18

## Dear customer

Thank you for choosing our Diagnostic PRO MESH nebulizer. In order to use the device properly and obtain the highest efficiency, please read this manual thoroughly and keep it for future reference.

## Intendend use

This device is to be used by healthcare professionals and patients at home instructed by their doctors with regard to medication dosage. The user is obliged to read and understand the working principle of the device and contents of this manual.

This device is intended for nebulization treatments of the upper and lower airways and allows a medical inhalant formulation to reach the bronchi and lungs. Do not use the device in any manner other than intended.

## Intended user

Adult and pediatric patients suffer from asthma, Chronic Obstructive Pulmonary Disease (COPD) such as emphysema and chronic bronchitis, or other respiratory diseases that are characterized by obstruction to air flow.

## Environment

This product is intended for use in a medical facility, such as hospital, clinic and doctor's office, in a room of general household, and in open-air environment with a roof.

## Important information

- Every user should use a separate kit of accessories (medication chamber, mask, mouthpiece) for hygiene reasons.
- These parts of mouth piece and masks can be reused after disinfecting treatment (please refer how to disinfection page 8)
- The nebulizer is a medical device. Please follow doctor's recommendations regarding a medication and dosage.
- Note that nebulization performance and rate is different for various medications.
- As with any mechanical device, this product may become unusable due to an electrical outage, battery depletion, or mechanical failure. We recommend that you have spare batteries and a backup device available to you.

### WARNING!

- Do not use any products containing sodium hyaluronate and highly concentrated sodium chloride (from 3% up).
- Do not use any liquids containing ester, greasy particles (including diffusion juice or herbal extract)
- Do not use essential oils!

## SAFETY PRECAUTIONS

To ensure safe and correct use of this product, please read the instruction manual carefully before using.



### **WARNING!**

- Treatment with this device does not substitute a medical assessment. In case of any health problems you should consult a healthcare specialist at first.
- Always follow doctor's recommendations regarding medication type, dosage, frequency and nebulization duration.
- Use only medications prescribed by a doctor.
- When using the device follow ordinary hygiene precautions.
- Do not place any liquid in the medication chamber that is not prescribed by a physician (except for saline solution).
- If you are using the nebulizer for the first time after purchasing it or you have not used it for a long time, please clean the nebulizer parts. (Please see page 8)
- After each use, please clean the medication chamber, and mouthpiece with distilled water (Please see page 8).
- Do not plug or unplug the AC adapter with wet hands.

### **CAUTION**

- If you notice that no mist is coming out of the spray nozzle, turn off the device immediately using the START/STOP button to avoid the mesh breaking.
- Please clean the nebulizer parts carefully after each use. Otherwise it may not function.
- Do not fill the nebulizer with ordinary tap water. Do not turn the device on if the medication chamber is filled with water. Clean the medication chamber with distilled water only.
- Please do not allow Q-tips or any foreign objects to come in contact with the mesh of the medication chamber. Otherwise the unit may not function.
- Do not expose the device to strong shocks and high humidity. Avoid exposing the device to external forces e.g. sources of electromagnetic fields. These environment factors may cause abnormal work of the device.
- To avoid abnormal work of the nebulizer due to electromagnetic disturbances do not use the device in vicinity of mobile phones and microwave ovens.
- Do not use the AC adapter other than the one specifically designed for this product
- Do not mix different types of batteries from different manufacturers.
- Do not store and transport the nebulizer with the medication or other substance filled inside.
- Do not immerse the main unit and the power adapter in water.

- Do not store the device in accommodations with high air humidity (e.g. bathroom) or if the main unit or the power adapter is wet.
- Store the device outside the reach of children. The device may contain small parts that can be swallowed.
- The device is not intended to be used by children or physically / mentally disabled person. Keep the package with the device out of reach of children.
- The device should not be used by operators lacking appropriate experience and knowledge regarding its safe use. In this case they should be supervised by adults responsible for their safety.
- Do not store the device in vicinity of heat sources.
- Do not use the device in accommodations in which aerosols were used (e.g. hair lacquer). Ventilate the room before nebulization.
- Store the device in places protected from harmful environment conditions (e.g. extreme temperatures, contamination, dust, sunlight, heat, cold).

## PRODUCT FEATURES

1. Pocket-sized and easy to carry.
2. Low power consumption and low residual medication volume (the amount of the medication which remains after the nebulization is finished).
3. The device turns off automatically after 5 minutes of operation.

## Components

The product package includes the following parts (see: figure below). In case any part is missing, please contact the manufacturer immediately. Safe and proper device functioning is guaranteed only when using original parts, recommended by the manufacturer.

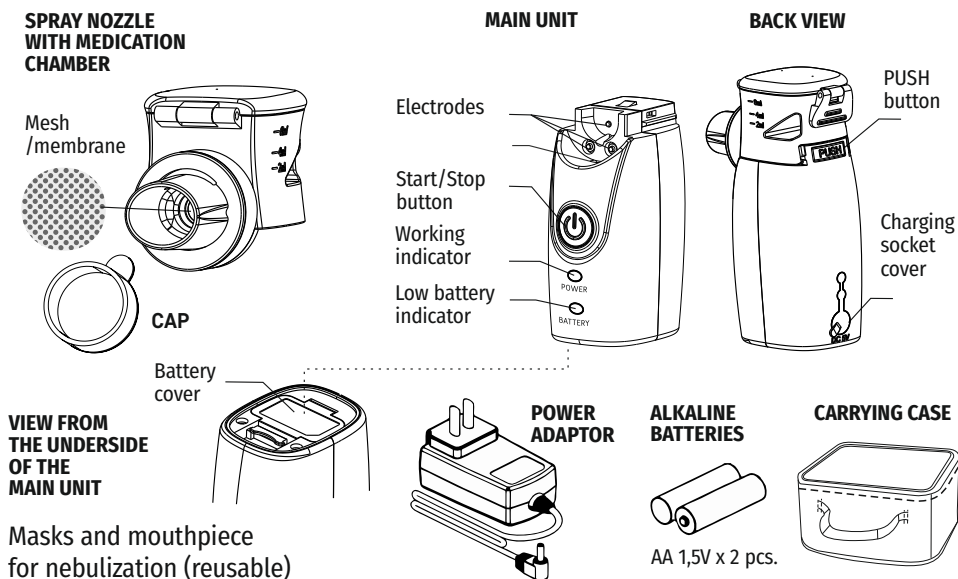

## Components and Materials

Medication chamber	Polycarbonate
Mouthpiece	Polyethylene
Pediatric/Adult masks	Polyvinyl Chloride (PCV)
Main unit	ABS

## How to assemble the nebulizer

### 1. Attach the medication chamber to the main unit:

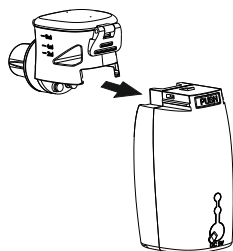

#### CAUTION

- Please ensure that the medication chamber is attached correctly; otherwise, it may result in a bad connection and the nebulizer may not function properly.
- Please keep the electrodes of main unit and medication chamber clean; otherwise, the nebulizer may not function properly.

Proper medication chamber assembly is signaled by a "click" sound.

## 2. Attach the mouthpiece or mask

Securely attach the mouthpiece or mask to the spray nozzle of the device.

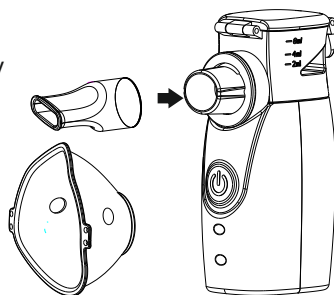

## How to connect to the power supply

The device may be powered with batteries or power adapter (optionally).

### 1. Battery power

1. Open the battery cover.

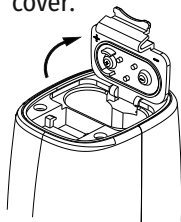

2. Place 2 batteries with their terminals properly oriented.

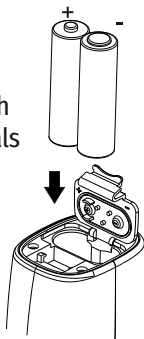

3. Close the battery cover.

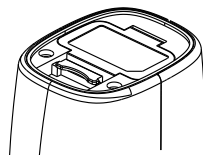

### 2. Battery life and replacement (attached)

- Up to 30 min of continuous use (6 nebulization cycles, 5 minutes each, 2 AA alkaline batteries supplied) or 4 days if used 3 times a day for 10 minutes (2 nebulization cycles, 5 minutes each).
- The battery indicator blinks in orange when the battery is almost depleted. In this case the user should replace the batteries.
- If the battery indicator lights up in orange, the batteries are depleted and the device cannot be used. Replace the batteries.

### ATTENTION

- Do not mix different types of batteries.
- **Battery life may be different depending on type of the batteries used.**
- Store batteries out of reach of children.
- Do not charge, heat and burn batteries.
- Battery leakage may damage the device. If the device is not to be used for prolonged time, take the batteries out.
- When replacing batteries check if the medication chamber is empty to prevent spillage of the medication.

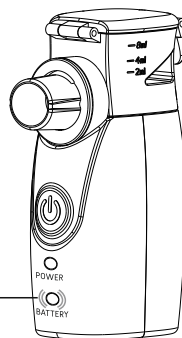

Low battery indicator

### 3. Using the power adapter

1. Plug the AC adapter's DC connector into the charging socket of the main unit.

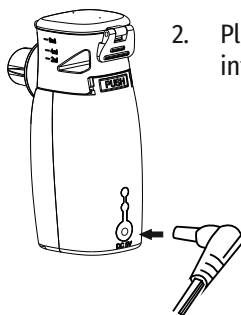

2. Plug the AC adapter into an electric outlet.

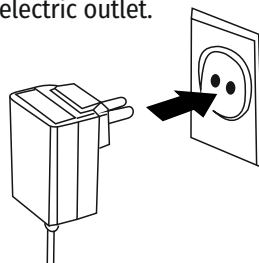

#### CAUTION

- Use only power adapter designated for this device. Do not use power adapters from other manufacturers.
- Please unplug the AC adapter after using. Do not leave it connected to the power supply for a long time.

### How to fill the device with medication

Please detach the rubber cap from the spray nozzle at first.

#### 1. Press the PUSH button and detach the spray nozzle together with the medication chamber from the main unit

Press the PUSH button on the rear side of the main unit and push the medication chamber toward the front side of the main unit.

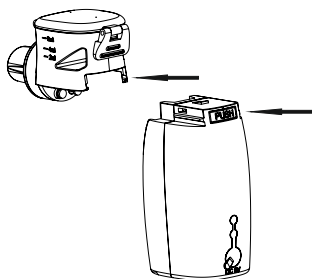

#### ATTENTION

- To avoid damaging the nebulizer, please ensure the PUSH button is pressed down before pushing the medication chamber forward.
- To avoid rupturing the mesh, please do not poke it with your finger or other objects.

#### 2. Pour the medication into the medication chamber

- Open the medication chamber cover and fill it with the medication. Recommended volume: 2-8 ml (max.)
- Close the medication chamber cover.

#### ATTENTION

- To prevent the medication leaking from the chamber, ensure the cover is closed securely.
- The filling process should be done while the chamber is detached from the main unit.

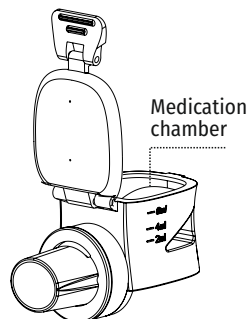



### 3. Re-attach the medication chamber to the main unit:

- Attach the medication chamber while it gives off a sound “Click”.

#### ATTENTION

- In order to prevent defects related to faulty connections, make sure the medication chamber is attached correctly.
- To ensure the nebulizer will function properly, keep the electrodes of the main unit and the medication chamber clean.

### 4. Attach the mouthpiece or mask

- Securely attach the mouthpiece or mask to the spray nozzle of the device.

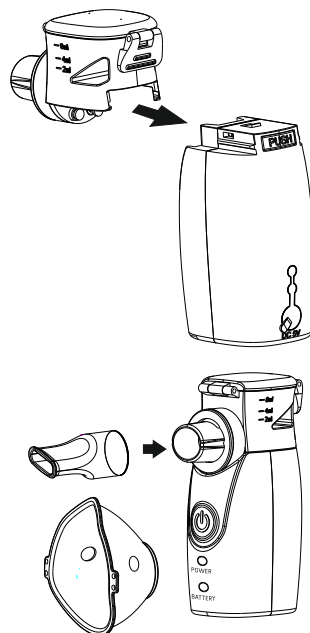

## HOW TO OPERATE THE NEBULIZER

You can also fill a 0.9 % Sodium Chloride (saline solution) solution in the medication chamber and then press “START/STOP” button for a function test after reassembly and before use. If the nebulizer can not spray out, please go to page 12 for troubleshooting.

### 1. Turn on the power:

Press the “START/STOP” button, and the POWER indicator (green) will light constantly. And medication chamber will be lit with blue color constantly .

#### ATTENTION

1. If the medication chamber is empty and the power is on, the POWER indicator lights up for about 0,5 s (green color), changes color to orange, and then, after about 8 s, the device turns off automatically.
2. When the medication is used the POWER indicator switches to orange and the medication chamber's backlit turns on; then the device turns off automatically.
3. **Some medications can make the device turn off automatically. In this case, after the inhalation, turn off the nebulizer using the START/STOP button to avoid the mesh breaking.**
4. **Do not use ordinary tap water to prevent the device malfunction.**

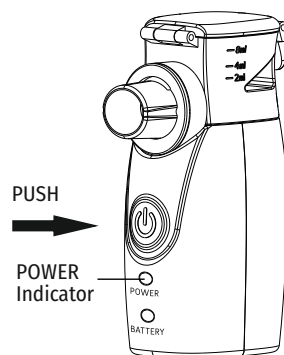

## 2. Nebulization

Keep the nebulizer steady in your palm and start nebulization using a proper mask

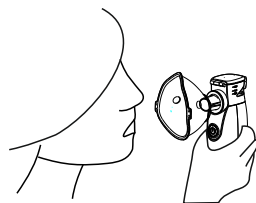

**ATTENTION:** If the device detects no medication in medication chamber, it will shut off automatically.

- **If the device does not turn off automatically when the medication is depleted, press the START/STOP button to turn off the power immediately, to avoid the mesh breaking. Read information on troubleshooting on page 12.**
- During the treatment, you may adjust the nebulizer to any angle. However, make sure the medication stays in contact with the mesh; otherwise, the nebulizer will shut off automatically after approximately 15 seconds.
- **When the medication is about to be depleted, it is recommended that you tilt the nebulizer slightly toward you. This enables the medication to stick to the mesh and continuing nebulization.**
- Please do not shake the nebulizer during operation as it can cause the device to shut off automatically.
- Children may use the nebulizer only when supervised by adults.
- **The device has an automatic 5-minute switch. Regardless of the amount of medicine left in the container, the device stops operation after 5 minutes. In order to continue nebulization, press START.**

## 3. Turn off the power

- The inhalator turns off automatically when there is no more medicine left or after 5 minutes of operation.
- The nebulizer shuts off automatically after the medication is depleted. Press If you wish to halt the treatment, press the "START/STOP" button to turn the power off. The POWER indicator light will go out.
- If the AC adapter is being used, please unplug it from the wall outlet at the end of nebulization.

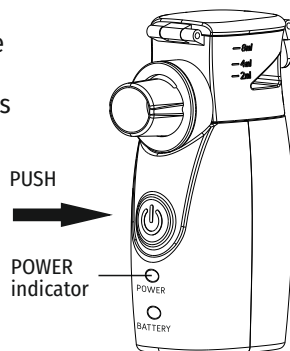

## Cleaning and disinfection

**Before the first use and immediately after every use please clean the device using distilled water !**

### 1. Cleaning mode

- Disconnect the medicine container from the main device.
- Open the cover of the medication chamber and discard the remaining medication.
- Pour about 4 ml of distilled water into the medication chamber and close the cover.

- Shake the medicine container energetically for around 10 seconds. Then, remove the contents and refill with 1 ml of distilled/demineralized water.
- Press and hold the START/STOP button for 5 seconds; the POWER buttons starts to flash in orange and the medication chamber backlit turns on in blue. Leave the nebulizer on for about 2 minutes to remove the medication residue from the medication chamber or until the remaining contents is removed.

### CAUTION

- If the device emits high frequency acoustic signal after distilled water is depleted, turn the device off to prevent damaging the mesh.
- Please clean the remaining medication after each use. Otherwise, the mesh of the medication chamber may become blocked.



### Additional cleaning of the medication chamber

If the mesh is clogged wholly or partially (no or little mist is coming out), it is recommended to clean the medication chamber with a vinegar solution. Solution preparation: to 1 part of distilled vinegar add 4 parts of boiled water. Pour this solution directly onto the mesh from the mouthpiece side (see the adjacent illustration).

After 10 minutes, pour out the solution and pour the water and vinegar solution (2 ml) once again, this time directly into the medication chamber.

Start the inhalator and let it operate until all the contents are used or until it automatically turns off. The nebulizer should turn off automatically when the solution is depleted. After cleaning the medication chamber with the vinegar solution, clean again using demineralized water as described in 1.

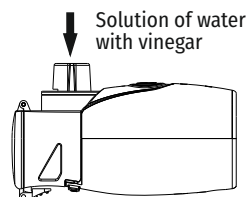

## 2. Dismantle the nebulizer

Disconnect the medication chamber and the mask or mouthpiece from the medication chamber. Immediately after every use clean the mask and mouthpiece using distilled, mineral or boiled water and dry all the elements. Use the accessories only after performing proper disinfection routines (see disinfection information on page 9). Replace the mask and mouthpiece if damaged.

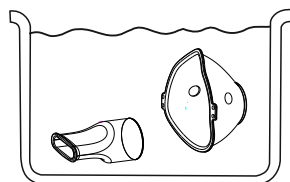

## 3. Dry the cleaned parts thoroughly:

After the parts are cleaned, dry with new gauze and air dry thoroughly.

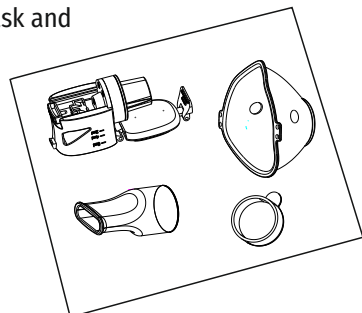

**ATTENTION**

- Please do not dry with cotton or cloths of other materials; otherwise, dust or cloth fiber may be left on the mesh, causing the nebulizer to malfunction.
- Please do not allow cotton tips or foreign objects in contact with the mesh of the medication chamber.

**4. Wipe off the main unit with gauze**

Dab a piece of gauze with water and lightly wipe off the stains from the main unit. Then, use new gauze to dry. Clean the electrodes with Q-tips to ensure proper electrical conductivity. Store all the part in a clean environment.

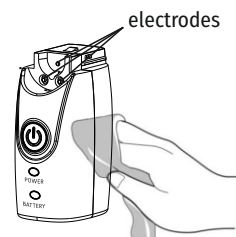
**5. Disinfecting**

In case of infectious diseases disinfect or sterilize the mouthpiece and mask after every use. You can also use alcohol or other common alcohol-based disinfectant sprays. Make sure that no disinfectant residues are left behind on the attachments to ensure safe nebulization when next used.

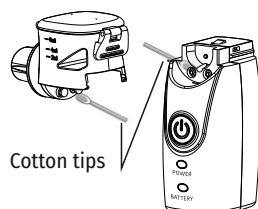

- Disinfect mouthpiece, and mask by boiling at 100°C for 3 minutes
- Don't boil the medication chamber, or damage may occur.

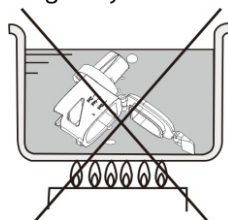
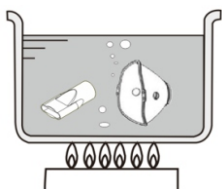

- Dry all the elements thoroughly.

**How to replace the medication chamber**

The medication chamber is a replaceable part with life span of about 6 months in normal working conditions (usage 3 x day for 15 minutes). Depending on the medications type and usage method the nebulization performance of the medication chamber may drop earlier. If the nebulizer does not work properly or nebulization rate dropped substantially, replace the medication chamber for a new one.

**1. Remove the medication chamber from the nebulizer**

- Press the PUSH button on the rear side of the main unit.
- Push the medication chamber toward the front side of the main unit.

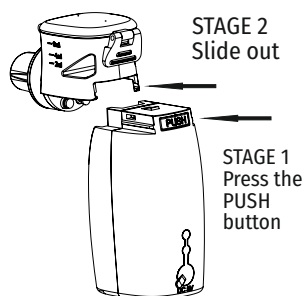

**ATTENTION**

- To avoid damaging the nebulizer, please ensure the PUSH button is pressed down before pushing the medication chamber forward.
- To avoid rupturing the mesh, please do not poke it with your finger or other foreign object.

**2. Attach the medication chamber back to the main unit**

Properly attach the medication chamber.

**ATTENTION**

- Check if the medication chamber is properly connected in order to prevent malfunctions related to faulty connections and improper performance.
- Before using the device clean the medication chamber.

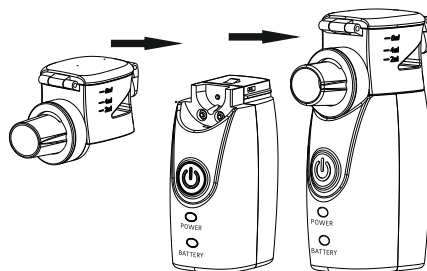
**How to store the nebulizer and accessories**

To properly disconnect all the accessories follow the instructions below. After disconnecting place the accessories in the case.

**1. Dismantle the nebulizer**

Detach the mouthpiece / nebulization mask.

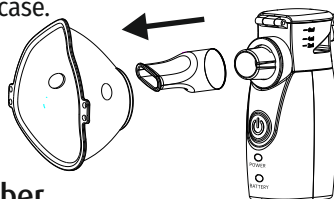
**2. Place the cap onto the medication chamber**

The cap protects the nebulizer from damaging during transportation.

**3. Place the nebulizer and accessories in the case**

- Do not move / transport the nebulizer with medication / water filled inside. There is a risk of medication spillage which can cause damage to the nebulizer.
- Do not store the nebulizer in places of high temperature, humidity and do not expose the device to direct sunlight.
- Remove the batteries if you are not going to use the nebulizer for a long period.

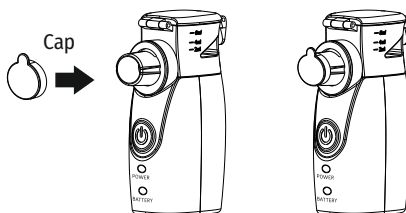

# Troubleshooting

Please refer to the table below to troubleshoot any problems you may encounter when using the nebulizer.

PROBLEMS	POSSIBLE CAUSES	SOLUTIONS
No / little mist discharging from the device	Medication chamber is not completely attached.	Re-attach the medication chamber correctly and restart the power. (See page 4)
	No contact between medication and mesh for more than 15seconds.	Tilt the device to enable the medication to stick to the mesh.
	Mesh of medication chamber is clogged.	Clean the medication chamber. (See page 8).If it still cannot be used after cleaning, please replace with a new medication chamber (See page 10).
	Electrodes on medication chamber are clogged with medication or water.	Clear the electrodes of clogged medication or water and restart the power. (See page 9)
	Water vapour condensation on membrane	Turn the device off and wait several minutes.
After turning power on, POWER indicator lights for one second and then immediately goes out.	Medication chamber is not completely attached.	Re-attach the medication chamber correctly and restart the power. (See page 4)
	No medication in medication chamber.	Put in the medication in the medication chamber. (See page 6)
	No contact between medication and mesh.	Tilt the device to enable the medication to stick to the mesh. (See page 8)
	Electrodes on medication chamber are clogged with medication or water.	Clear the electrodes of clogged medication or water and restart the power. (See page 9)

PROBLEMS	POSSIBLE CAUSES	SOLUTIONS
POWER indicator is not lit and the nebulizer does not work	Batteries installed backwards.	Re-install the batteries in the correct orientation and restart the power. (See page 5)
	Low battery power.	Replace with new batteries and restart the power. (See page 5)
	Incorrect connection of AC adapter to nebulizer.	Re-connect in the correct manner and restart the power. (See page 6)
The POWER indicator is on but the nebulizer does not work.	The low battery indicator is on in orange; battery too weak or depleted.	Replace with new batteries and restart the power. (See page 5)
	Rupture of mesh of medication chamber.	Replace with a new medication chamber and then put in the medication. (See page 10)
	Electrodes on medication chamber are clogged with medication or water.	Clear the electrodes of clogged medication or water and restart the power. (See page 9)
	Mesh of medication chamber is severely clogged.	If it still cannot be used after cleaning, please replace with a new medication chamber. (See page 10)
	Water vapour condensation on membrane	Turn the device off and wait several minutes.

PROBLEMS	POSSIBLE CAUSES	SOLUTIONS
Nebulizer shuts off in usage.	Medication chamber is loosened and not completely attached.	Re-attach the medication chamber correctly and restart the power. (See page 4)
	The plug connecting the mains adapter to the device is not properly inserted.	Re-connect in the correct manner and restart the power. (See page 6)
	Medication has run out.	Put in the medication in the medication chamber. (See page 6)
	No contact between medication and mesh for more than 15 seconds.	Adjust the nebulizer's angle so the medication can come in contact. (See page 8)
Nebulizer does not shut off automatically while medication depleted.	The nebulizer is exposed to excessive vibrations during usage.	Hold the nebulizer steadily in your hand.
	Medication chamber is broken.	Replace with a new medication chamber and then put in the medication. (See page 10)
	Some type of medications for nebulization maybe cause to produce a lot of foam in the medication chamber.	Clean the foam and restart the power. (See page 8)
	Electrodes on medication chamber are clogged with medication or water.	Clear the electrodes of clogged medication or water and restart the power. (See page 9)
Overflow of medication from medication chamber.	Medication chamber is broken.	Purchase and replace with a new medication chamber. (See page 10)

If your nebulizer does not work properly after using abovementioned measures, contact the distributor or the manufacturer.



# Specifications

Method of Operation	Ultrasonic
Dimensions	Approx. 72 mm(L) × 40 mm(W) × 113 mm(H)
Weight	Approx. 98 g (Exclude batteries)
Power Supply	3V DC ("AA" 1.5V alkaline battery x 2) AC adapter, Input: 100-240V AC, 50/60Hz, 0.2A Output: 5V DC, 1A
Power Consumption	Approx. 1.2W
Vibrating Frequency	Approx. 113kHz
Nebulization Rate	>0.25 ml/min minimum
Noise level	<50 dB (at a distance of 1m)
Particle Size	MMAD 3.8 um
Recommended fill volume	8 ml maximum 2 ml minimum
Battery Life	Attached batteries lifespan - up to 30 minutes (6 nebulizations for 5 minutes) or 4 days when used 3 times a day for 10 minutes 2 nebulisations per 5 min. each).
Durable period	Main unit: 3 years Medication chamber: 6 months Durable periods are as follows, provided the product is used to nebulizer saline 3 times a day for 15 minutes each time at room temperature (23°C). Durable period may vary depending on usage environment. Immediately replace damaged mask or mouthpiece for a new one.
Allows operation in all directions	Upside down or tilted for up to 15 seconds
Detection if no medication	LED Orange LED indicator (POWER) turns on for 8 sec, then power supply turns off.
Automatic switch off	The nebulizer gives off the high frequency sound and shuts off automatically if the medication is not in contact with the mesh of the medication chamber for more than 15 seconds (time varies for different types of medication) or the medication is depleted. This is to help prevent damage to the mesh.
Operating Conditions	Temperature: 10 ~ 40 °C (50 ~ 104 °F); Humidity: 15 ~ 93 % R.H. Atmospheric Pressure: 800-1060 hPa
Storage and Transportation Conditions	Temperature: -20 ~ 70 °C (-4 ~ 158 °F); Humidity: ≤93 % R.H. Atmospheric Pressure: 800 - 1060 hPa
Packaging Contains	Main unit, Spray nozzle cap, mouthpiece, pediatric mask, adult mask, spray nozzle with medication chamber, alkaline batteries, case, instructions manual, power adapter

The manufacturer reserves the right to change the technical parameters of the device without notice.

## SPRAYED PARTICLES MAGNITUDE

as per EN 13544-1

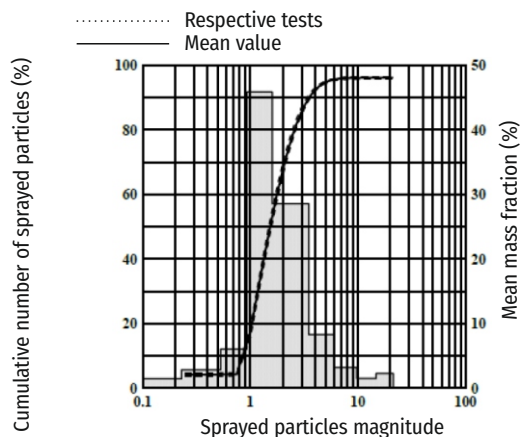

The data changes according to the medication type. The measurements were conducted with the use of laser diffraction and saline solution technique. The data may not be applicable with regard to suspensions or highly viscous medications. Please contact the medication manufacturer.

## Accessories / Replacement parts

Contact the manufacturer or distributor to order the following accessories.

### 1. Medication chamber

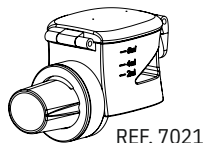

### 2. Mouthpiece



### 3. Reusable nebulization masks:

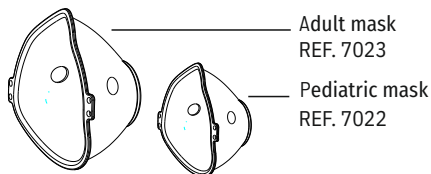











## IMPORTANT NOTE

This equipment has been tested and found to comply with the limits for a Class B digital device, pursuant to Part 15 of the FCC Rules. These limits are designed to provide reasonable protection against harmful interference in a residential installation. This equipment can generate, use and radiate radio frequency energy and, if not installed and used in accordance with the instructions, may cause harmful interference to radio communications. However, there is no guarantee that inference will not occur in a particular installation. If this equipment does cause harmful inference to radio or television reception, which can be determined by turning the equipment off and on, the user is encouraged to try to correct the inference by one or more of the following measures:

- Reorient or relocate the receiving antenna.
- Increase the separation between the equipment and receiver.
- Connect the equipment into an outlet on a circuit different from that to which the receiver is connected.
- Consult the dealer or an experienced radio/TV technician for help.

## Symbols description

	Attention		Year of production		Manufacturer
	Class II insulation		BF type device	SN	Serial number
	Direct current		Consult the instruction manual	Rev.	Last updated
IP22	Degree of protection		Protect against humidity		Power adaptor plug polarity
	Catalog number		Protect against sunlight		



The worn out product should be taken to a waste collection facility. Contains components that are dangerous for the environment. The correct disposal of the device allows to preserve valuable resources and avoid negative effects on health and the environment, which may be threatened by inappropriate handling of waste. If you are in doubt where to return the used appliance, contact Diagnosis or your local distributor.

## ELECTROMAGNETIC COMPATIBILITY

### Guidance and Manufacturer's declaration – electromagnetic emissions

The device is intended for use in the electromagnetic environment specified below.  
The customer or the user of the device should assure that it is used in such an environment.

Emissions test	Compliance	Electromagnetic environment – guidance
RF emissions CISPR 11	Group 1	The device uses RF energy only for its internal function. Therefore, its RF emissions are very low and are not likely to cause any interference in nearby electronic equipment.
RF emissions CISPR 11	Class B	The device is suitable for use in all establishments, including domestic establishments and those directly connected to the public low-voltage power supply network that supplies buildings used for domestic purposes.
Harmonic emissions IEC 61000-3-2	Not applicable	
Voltage fluctuations/ flicker emissions IEC 61000-3-3		

## Guidance and Manufacturer's declaration – electromagnetic immunity

RF – electromagnetic spectrum frequency value between the lower radio frequency range and the infrared range; the frequency useful for radio transmission. The limit values are generally considered to equal 9 kHz nad 3 000 GHz.

The DEVICE is intended for use in the electromagnetic environment specified below.  
The customer or the user of the DEVICE should assure that it is used in such an environment.

Immunity test	IEC 60601 test level	Compliance level	Electromagnetic environment – guidance
Electrostatic discharge (ESD) IEC 61000-4-2	±6kV contact ±8 kV air	±6kV contact ±8 kV air	Floors should be wood, concrete or ceramic tile. If floors are covered with synthetic material, the relative humidity should be at least 30 %.
Electrical fast transient/burst IEC 61000-4-4	± 2kVfor power supply lines ± 1kVfor input/output lines	Not applicable	Mains power quality should be that of a typical hospital or commercial environment.
Surge IEC 61000-4-5	± 1kV differential mode ± 2kV common mode	Not applicable	Mains power quality should be that of a typical hospital or commercial environment.
Interruptions and voltage variations on power supply input lines  IEC 61000-4-11	<5 % UT (>95 % dip in UT) for 0,5 cycle 40 % UT (60 % dip in UT) for 5 cycles 70 % UT (30 % dip in UT) for 25 cycles <5 % UT (>95 % dip in UT) for 5 sec	Not applicable	Mains power quality should be that of a typical commercial or hospital environment. If the user [of the device or system] requires continued operation during power mains interruptions, it is recommended to use an uninterrupted power supply.
Power frequency (50/60 Hz) magnetic field IEC 61000-4-8	3 A/m	3 A/m	Power frequency magnetic fields should be at levels characteristic of a typical location in a typical commercial or hospital environment.

NOTE UT is the AC mains voltage prior to application of the test level.

RF – electromagnetic spectrum frequency value between the lower radio frequency range and the infrared range; the frequency useful for radio transmission. The limit values are generally considered to equal 9 kHz nad 3 000 GHz.

Guidance and manufacturer's declaration – electromagnetic immunity – for device that is not LIFE-SUPPORTING. Guidance and manufacturer's declaration – electromagnetic immunity. The device is intended for use in the electromagnetic environment specified below. The customer or the user of the device should assure that it is used in such an environment.

Immunity test	IEC 60601 test level	Compliance level	Electromagnetic environment – guidance
Conducted RF IEC 61000-4-6	3 Vrms 150 kHz do 80 MHz	3V	Portable and mobile RF communications equipment should be used no closer to any part of the device, including cables, than the recommended separation distance calculated from the equation applicable to the frequency of the transmitter. Recommended separation distance $d = 1,2 \sqrt{P}$ $d = 1,2 \sqrt{P}$ 80 MHz to 800 MHz $d = 2,3 \sqrt{P}$ 800 MHz to 2,5 GHz where P is the maximum output power rating of the transmitter in watts (W) according to the transmitter manufacturer and d is the recommended separation distance in meters (m). Field strengths from fixed RF transmitters, as determined by an electromagnetic site survey, should be less than the compliance level in each frequency range. Interference may occur in the vicinity of equipment marked with the following symbol: $d = 1,2 \sqrt{P}$ 
Radiated RF IEC 61000-4-3	3 V/m 80 MHz do 2,5 GHz	3V/m	

NOTE 1 At 80 MHz and 800 MHz, the higher frequency range applies.

NOTE 2 These guidelines may not apply in all situations. Electromagnetic propagation is affected by absorption and reflection from structures, objects and people.

a) Field strengths from fixed transmitters, such as base stations for radio (cellular/cordless) telephones and land mobile radios, amateur radio, AM and FM radio broadcast and TV broadcast cannot be predicted theoretically with accuracy. To assess the electromagnetic environment due to fixed RF transmitters, an electromagnetic site survey should be considered. If the measured field strength in the location in which the device is used exceeds the applicable RF compliance level above, the device should be observed to verify normal operation. If abnormal performance is observed, additional measures may be necessary, such as reorienting or relocating the device.

b) Over the frequency range 150 kHz to 80 MHz, field strengths should be less than 3 V/m.

RF – electromagnetic spectrum frequency value between the lower radio frequency range and the infrared range; the frequency useful for radio transmission. The limit values are generally considered to equal 9 kHz nad 3 000 GHz.

Recommended separation distances between portable and mobile RF communications equipment and the device – for device that is not IFE-SUPPORTING

Recommended separation distances between portable and mobile RF communications equipment and the device. The device is intended for use in an electromagnetic environment in which radiated RF disturbances are controlled. The customer or the user of the device can help prevent electromagnetic interference by maintaining a minimum distance between portable and mobile RF communications equipment (transmitters) and the device as recommended below, according to the maximum output power of the communications equipment.

Rated maximum output power of transmitter W	Separation distance according to frequency of transmitter m		
	150 kHz do 80 MHz d = 1,2	80 MHz do 800 MHz d = 1,2	800 MHz do 2.5 GHz d = 2,3
0,01	0,12	0,12	0,23
0,1	0,38	0,12	0,73
1	1,2	1,2	2,3
10	3,8	3,8	7,3
100	12	12	23

For transmitters rated at a maximum output power not listed above, the recommended separation distance d in meters (m) can be estimated using the equation applicable to the frequency of the transmitter, where P is the maximum output power rating of the transmitter in watts (W) according to the transmitter manufacturer.  
 NOTE 1 At 80 MHz and 800 MHz, the separation distance for the higher frequency range applies.  
 NOTE 2 These guidelines may not apply in all situations. Electromagnetic propagation is affected by absorption and reflection from structures, objects and people.



store stamp and signature of salesperson

## Warranty card

DEVICE NAME .....

MODEL .....

SERIAL NUMBER .....

DATE OF SALE .....

## Warranty terms

1 Diagnosis S.A. grants a warranty:

- 24 months for Nebulizer Diagnostic PRO MESH
- 6 months warranty for Medication Chamber and Spray Nozzle
- Replacement parts such as mouthpiece, masks are excluded from the guarantee.

Hardware defects revealed during the warranty period will be rectified free of charge within 21 days. The term runs from the date of delivery of the equipment to the service center.

2. The purchaser shall be entitled to replace the equipment for a new one, free of defects, when:

- the repair has not been made within the time limit set in item 1
- an authorized service center found an irreparable manufacturing defect
- during the warranty period, 4 repairs were effected, and the equipment still shows defects
- that prevent its use in accordance with its intended purpose.

The concept of repair shall not include operations related to equipment check and cleaning.

3. The warranty shall not cover: batteries, products with illegible or damaged serial number, damage due to the operation and storage inconsistent with the user manual, ingress of liquids or foreign bodies, overvoltage of mains, repairs by unauthorized persons and random events.
4. Faulty equipment should be delivered by the buyer to the address of the distributor in your country.
5. The warranty for the sold consumer goods shall not exclude, restrict, or suspend the powers of the buyer resulting from non-conformity of the goods with the contract.
6. The only basis for the warranty rights shall be the warranty card with the date of sale, stamp and signature of the salesperson. If the card is not completed, filled in wrongly, with traces of corrections and entries made by unauthorized persons, illegible as a result of damage - it shall be invalid.

